



51

## Glueing Console Series NKK



- Alternative to welding
- Innovative joining technique
- Stable and tested bonding
- Simple mounting
- Easy to clean
- Especially suitable for stainless steel constructions



NKK G

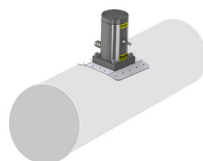

NKK R

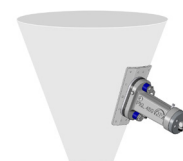

NKK K



## Glueing Console Series NKK

Type*	Usable vibrators and impactors**										Dimensions	
	NCB	NCR	NCT	NTP	NTS	NTK	PKL	NEA NEG	NEA S NEG S	NED	A [mm]	B [mm]
NKK G 010				18	80						49	70
NKK G 050	1, 2	3	1, 2, 3 4, 4i		120, 180	8 AL					79	100
NKK G 100	3, 5, 10, 20	10	5, 10, 10i	25	250, 350 100/01	15 X, 16 18 AL	190				109	140
NKK G 200	50, 70	22, 57	15, 29 29i, 55 108, 108i	32	75/01 50/01	25, 25 AL 28 AL 40, 40 AL	450	504			129	220
NKK G 300		120	126, 250 250i	48	70/02 54/02		740, 1000	5020, 5050 5060, 50120 50200	5020 5050	50100	170	240
NKK G 400					50/04 21/04		2100	50300	50120	50200	210	290
NKK G 500							5000				230	320
NKK R	for cylindrical component shape										Dimensions are customer-specific	
NKK K	für conical component shape											

\* G = suitable for flat component shape, R = suitable for round component shape, K = suitable for conical component shape  
\*\* For each glueing console only one vibrator or impactor is usable. Multiple assembly not possible.

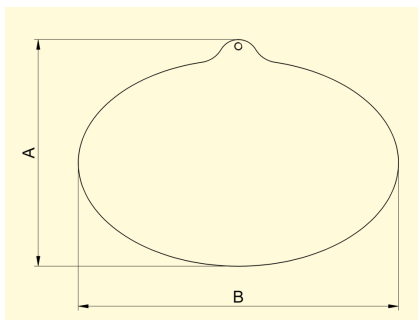

Dimensions NKK G



NCR on NKK G for deaerating fluids



PKL on NKK K for loosening adhesions

### Application areas

The alternative to welding: With glueing console of the series NKK vibrators and impactors can be easily and securely attached to steel or stainless steel components such as containers, silos, pipes or other assemblies. Impactors and vibrators are also applied for cleaning, loosening or emptying. The innovative joining technique „glueing“ does not require any heat input and therefore does not form cracks or fractures. Thus, this gentle process guarantees material integrity.

### Design and function

The glueing console of the series NKK can be mounted very easily and during ongoing production. All parts needed for glueing are available as a set. The console serves as a connecting element between vibrator and construction. After pre-cleaning of the surfaces to be glued, the glueing console can be attached. After a curing time of twelve hours, vibrators or impactors can be mounted and the console fully loaded.

### Features

Glueing consoles are particularly suitable for use in the food industry. They are easy to clean. Console and glued joint can be subsequently painted after completion of assembly. In addition, consoles are available for ATEX areas. Talk to our application experts - also on site - which vibrator or impactor is suitable for your operational processes. We are happy to construct a tailor-made console for your component form and will assist and support you during installation.

### Ambient temperature

Installation: +15 °C to +40 °C  
Operation: -20 °C to +100 °C

**NetterVibration** offers the right accessories required for the mounting, installation and control of vibrators and interval impactors.

**Netter provides solutions. Consult our experienced application technicians.**

### Netter GmbH

Fritz-Lenges-Str. 3  
55252 Mainz-Kastel

- Germany
- Switzerland
- Poland
- Spain
- Australia

www.**NetterVibration**.com  
info@**NetterVibration**.com