



47

Netter Conveyor System Series *LineDrive*



- Gentle and constant conveying
- Flat, compact construction
- Modularly extendable
- Low air consumption
- Very low noise level





Netter Conveyor System Series *LineDrive*

The conveyor system of the *LineDrive* series consist of:



a conveyor trough, manufactured either by the client or as per client's requirements,

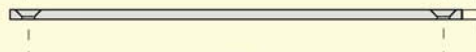

the mounting plate (optional)

LineDrive support NLD 25 A

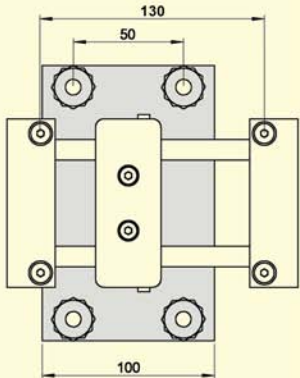
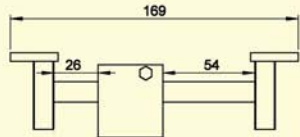

The LineDrive support is required as support for longer conveyors or for greater loads as well.

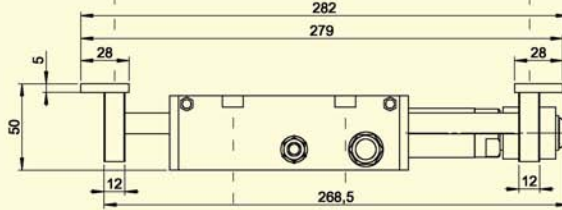

the *LineDrive* unit, driven by a linear vibrator



and the ground plate (optional).

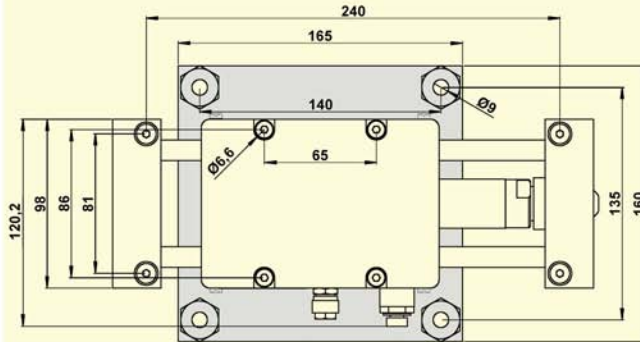

Conveyor system *LineDrive*



trough



mounting plate



drive unit



ground plate



support

Applications

The *LineDrive* conveyor system is suitable for gentle, horizontal conveying of bulk material. The flat design (height of drive 5 cm) allows applications even with confined space constraints.

Design and functioning principle

Traditional vibration conveyor systems work on the throwing principle, in which the product is "thrown" forward, following a trajectory parabola. With the *LineDrive* conveyor principle, the material slides along the conveyor trough. This is made possible by a pneumatic linear drive. The conveyor output can be adjusted to suit the specific characteristics of the material to be conveyed by regulating the compressed air. In longer conveyor systems (from approx. 2m), the trough is supported by the *LineDrive* support. It is possible to convey greater loads by coupling several *LineDrive* propulsion systems. In addition to the standard versions, customized variants of the *LineDrive* series are also available.

Mounting plates

The mounting plates are suitable for mounting the entire surface of the conveyor troughs on a *LineDrive* unit.

Baseplates

The ground plates are used to compensate unevenness in order to avoid any tensioning in the *LineDrive* unit.

Permissible operating conditions:

Drive Medium:

Compressed air or nitrogen (filter $\leq 5 \mu\text{m}$), preferably with oil mist

Optimum Operating pressure:

2 bar.

Ambient temperature:

5°C to 60°C

Weight without trough:

2,7 kg

NetterVibration offers the accessories required for the mounting, installation, control and monitoring of vibrators and impactors.

Netter provides solutions.

Consult our experienced application technicians.

Netter GmbH

Germany

Fritz-Ullmann-Str. 9
55252 Mainz-Kastel
Tel. +49 6134 2901-0

Poland

Al. W. Korfatego 195/17
40-153 Katowice
Tel. +48 32 2050947

Switzerland

Erlenweg 4
4310 Rheinfelden
Tel. +41 61 8316200

Spain

Errota Kalea 8
20150 Villabona-Guipúzcoa
Tel. +34 943 694 994

www.NetterVibration.com
info@NetterVibration.com